

## Technical Guidelines

### 1 Preliminary Statements

#### 1.1 House Regulations / Extract from the House Regulations

#### 1.2 Opening Times

- 1.2.1 Construction and Dismantling Times
- 1.2.2 Duration of Event

### 2 Traffic on the Fair Grounds, Escape Routes, Safety Equipment

#### 2.1 Traffic Regulations

#### 2.2 Escape Routes

- 2.2.1 Fire Department Operation Zones, Hydrants
- 2.2.2 Emergency Exits, Emergency Hatches, Hall Aisles

#### 2.3 Safety Equipment

#### 2.4 Stand Numeration

#### 2.5 Security

#### 2.6 Emergency Evacuation

### 3 Technical Data and Equipment in the Halls and Outdoor Areas

#### 3.1 Hall Data

- 3.1.a Hall Overview
- 3.1.b Hall Height (Clear Span)
- 3.1.c Elevators
- 3.1.d Service Doors / Fireproof Door Shutters, Smoke Aprons
- 3.1.e Doors
- 3.1.f Technical Hall Information
  - 3.1.1 General Lighting, Type of Power, Voltage
  - 3.1.2 Compressed Air, Electrical and Water Supply
  - 3.1.3 Communications Facilities
  - 3.1.4 Sprinkler Systems
  - 3.1.5 Heating, Ventilation
  - 3.1.6 Faults

#### 3.2 Outdoor Areas

### 4 Stand Construction Regulations

#### 4.1 Stand Construction Safety

#### 4.2 Stand Construction Authorization

- 4.2.1 Inspection and Acceptance of Constructions which Require a Permit
- 4.2.2 Vehicles, Containers and Tents
- 4.2.3 Modifications to non-regulation Components

### 4.3 Overall Height

#### 4.4 Fire and Safety Regulations

- 4.4.1 Fire Protection
  - 4.4.1.1 Stand Construction and Decoration Materials
  - 4.4.1.2 Display of Motor Vehicles
  - 4.4.1.3 Explosive Substances / Munitions
  - 4.4.1.4 Pyrotechnics
  - 4.4.1.5 Use of Balloons and Flying Objects
  - 4.4.1.6 Fog Machines
  - 4.4.1.7 Smoking in the Halls
  - 4.4.1.8 Recycling Containers, Non-Recyclable Trash Containers
  - 4.4.1.9 Spraying Guns, Solvent-based paints
  - 4.4.1.10 Abrasive Cutting and Grinding Work and all Work / Demonstrations / Displays with Open Flames, Fireplaces and Fire Loads.
  - 4.4.1.11 Empty Containers
  - 4.4.1.12 Fire Extinguishers
- 4.4.2 Stand Covering
- 4.4.3 Glass and Acrylic Glass
- 4.4.4 Meeting Places

#### 4.5 Exits, Escape Routes, Doors

- 4.5.1 Exits and Escape Routes
- 4.5.2 Doors

### 4.6 Platforms, Ladders, Steps, Catwalks and Ramps

#### 4.7 Stand Design, Walls

- 4.7.1 Appearance
- 4.7.2 Checking the Rented Area
- 4.7.3 Changes to the Substance of the Building
- 4.7.4 Hall Flooring
- 4.7.5 Hanging Objects from the Hall Ceiling
- 4.7.6 Stand Partition Walls / System Stands
- 4.7.7 Advertising / Presentations / Outdoor Advertising
- 4.7.8 Barrier-free access

### 4.8 Outdoor Areas

### 4.9 Two-Storey Construction

## Technical Guidelines

### **5 Operational Safety, Technical Safety Regulations, Technical Code, Technical Supply**

#### **5.1 General Regulations**

5.1.1 Damages

#### **5.2 Use of Tools**

#### **5.3 Electrical Installation**

5.3.1 Connections

5.3.2 Stand Installation

5.3.3 Assembly and Operating Regulations

5.3.4 Safety Measures

5.3.5 Safety Lighting

#### **5.4 Water and Waste Water Installation**

#### **5.5 Compressed Air / Gas Installation**

5.5.1 Compressed Air

5.5.2 Gas

#### **5.6 Machine, Pressure Vessel and Exhaust Gas Facilities**

5.6.1 Machine Noise

5.6.2 Product Safety Law

5.6.2.1 Safety Devices

5.6.2.2 Test Procedures

5.6.2.3 Operating Ban

5.6.3 Pressure Vessels

5.6.3.1 Approval Confirmation

5.6.3.2 Testing

5.6.3.3 Rental Devices

5.6.3.4 Monitoring

5.6.4 Exhaust Gases and Vapors

5.6.5 Exhaust Gas Facilities

#### **5.7 Use of Compressed Gases, Liquid Gases and Combustible Fluids**

5.7.1 Compressed Gas and Liquid Gas Facilities

5.7.1.1 Approval Request for Compressed Gas Bottles

5.7.1.2 Use of Liquid Gas

5.7.1.3 Setup and Maintenance

5.7.2 Combustible Fluids

5.7.2.1 Storage and Use

5.7.2.2 Storage of Required Amounts

5.7.2.3 Storage Containers

5.7.2.4 Storage Location

5.7.2.5 Conditions for Operating

5.7.2.6 Filling with Liquids

5.7.2.7 Empty Containers

#### **5.8 Asbestos and Other Dangerous Substances**

#### **5.9 Film, Photography, Television and other Types of Presentations**

#### **5.10 Radiation Protection**

5.10.1 Radioactive Materials

5.10.2 X-Ray Facilities and Interference Radiators

5.10.3 Laser Facilities

#### **5.11 High Frequency Devices, Radio Systems, Electromagnetic Compatibility and Harmonic Oscillations**

#### **5.12 Cranes, Fork Lift Trucks, Empty Containers, Trade Fair Forwarding Agents, Customs**

5.12.1 Customs Clearance

#### **5.13 Musical Renditions**

#### **5.14 Drink Dispensing Machines**

#### **5.15 Food Monitoring**

#### **5.16 Import of Meat and Meat Products**

### **6 Environmental Protection**

#### **6.1 Waste**

6.1.1 Waste Disposal

6.1.2 Dangerous Waste

6.1.3 Waste Which Has Been Brought on Site

#### **6.2 Water, Waste Water, Ground Protection**

6.2.1 Oils, Fat Collectors

6.2.2 Cleaning / Cleaning Agents

#### **6.3 Environmental Damage**

### **7 Miscellaneous**

#### **7.1 Insurance / Stand Guards**

7.1.1 Insurance

7.1.2 Stand Guards

#### **7.2 Arranging Personnel**

#### **7.3 Hotel / Travel Services**

#### **7.4 Rental Furniture and Equipment**

#### **7.5 Catering**

### **8 List of keywords**

## Technical Guidelines

### 1 Preliminary Statements

Koelnmesse has issued guidelines for the trade fairs and other events held. These guidelines are intended to provide all exhibitors / organizers with the optimal conditions for presenting their exhibits and appealing to their visitors and other interested parties.

These guidelines are binding for all exhibitors and organizers.

These guidelines also contain regulations in the interests of our exhibitors and visitors which are designed to offer the highest degree of safety possible in regard to technical and design equipment at the event.

The building ordinance, fire protection and other safety regulations have been established in agreement with the responsible authorities of the city of Cologne. Third parties may not derive any rights from the permits or approvals granted to Koelnmesse.

In addition, the statutory regulations should always be observed in their currently valid version.

The responsible agencies and facilities reserve the right to verify that statutory or administrative agency regulations are being upheld.

The opening of an exhibition stand can be entirely or partly banned in the interest of all event participants if determined safety risks have not been eliminated by the time of the event opening.

The right to make additional demands regarding safety and stand construction is reserved.

The order forms for additional services are usually sent with the authorization. The orders must be completed and returned on time, as ASG/Koelnmesse will not assume responsibility for the performance of requested services in a proper or functional manner if the forms are received late.

ASG/Koelnmesse reserves the right to impose a surcharge on the prices mentioned in the order forms for those order forms which are received late, in accordance with the details specified in the order forms.

For information purposes, the exhibitors may be sent additional circulars with details regarding the preparation and organization of the event.

ASG/Koelnmesse would like to draw the exhibitors' attention to the fact that they must comply with all applicable labor and social security regulations. As far as the employment of foreign workers is concerned, only those people in possession of a permit that allows them to work on an employed or self-employed basis may work on the fair grounds.

The following trade fair companies:

Deutsche Messe AG Hannover

Koelnmesse GmbH

Landesmesse Stuttgart GmbH

Leipziger Messe GmbH

Messe Berlin GmbH

Messe Düsseldorf GmbH

Messe Frankfurt GmbH

Messe München GmbH

Nürnberg Messe GmbH

have drawn up these Technical Guidelines in a common classification structure.

Subject to further alteration.

The German text is binding.

## Technical Guidelines

### 1.1 House Regulations

#### House and Ground Regulations of ASG/Koelnmesse for the Cologne Trade Fair Grounds

1. These house and grounds regulations apply to all areas of the trade fair grounds in Cologne, i.e. all halls, outdoor areas and all buildings and grounds which have been let to ASG/Koelnmesse either temporarily or permanently. They apply to all persons who enter or spend time on the trade fair grounds in Cologne as defined above.

2. The domestic authority is exercised within the trade fair grounds in Cologne by the staff of ASG/Koelnmesse and/or the staff of the security companies employed by ASG/Koelnmesse.

3. ASG/Koelnmesse has the right to limit access to the trade fair grounds – and in particular to the halls – to exhibitors, visitors and other third parties, e.g. to allow access to trade visitors only and to monitor adherence to the admission conditions. The halls and other event areas may be entered only by those persons holding a valid admission ticket. This ticket must be shown on demand. Diverging access regulations – for exhibitors and companies working within the Cologne trade fair grounds in particular – are not affected by this regulation.

4. Children and young people below the age of 16 may enter the grounds during an event only when accompanied by an adult. Special notification will be given of diverging regulations. Adults and young people over the age of 16 enjoy unrestricted admission. Children below the age of six are admitted free of charge. An appropriate admission ticket must be purchased in all other cases. Event-related special regulations such as „for trade visitors only“ are not affected by this regulation.

Children and young people below the age of 16 who are not trainees of a company working on the trade fair grounds during the stand construction and stand dismantling periods are not permitted to enter the grounds during these periods.

5. The staff of ASG/Koelnmesse or the staff of the security companies employed by ASG/Koelnmesse who can identify themselves as such are permitted to check tickets on the fair grounds. Those found on the grounds without a valid admission ticket or other access authorisation, or those who are found on the grounds without permission must leave the grounds immediately.

6. As part of ASG/Koelnmesse's security concept, video surveillance is carried out at the exhibition centre.

7. ASG/Koelnmesse has the right to prohibit individuals from carrying bags and other containers with them inside the exhibition centre. For reasons of general security and the prevention of theft, bags and other containers that individuals carry with them are subject to spot checks or comprehensive checks at the entrances and exits of the exhibition centre. By entering the exhibition centre, people who carry bags or other containers with them give their consent to have these bags and containers checked.

8. Persons enter / drive onto the trade fair grounds at their own risk. Within the scope of the law ASG/Koelnmesse exclude any liability. The provisions of the Road Traffic Regulations (StVO) apply. Unless traffic conditions make it necessary to drive at walking pace, the speed limit is 30 km per hour. ASG/Koelnmesse have the right to impose pedestrian and vehicular access restrictions on the trade fair grounds, to refuse access or control access in any other way they deem fit.

9. ASG/Koelnmesse is liable only in cases of gross negligence and malicious intent, regardless of the legal grounds. In cases of simple negligence, ASG/Koelnmesse is only liable:

- for damages that affect anyone's life, health or physical well-being.
- for damages resulting from a breach of a basic contractual obligation (obligations that make the orderly implementation of the contract possible in the first place, and the observance of which the parties to the contract regularly rely on and can expect to rely on). In such a case, ASG/Koelnmesse's liability is limited to the compensation of the foreseeable, typically occurring damage. Liability for untypical, indirect or consequential damages is excluded.

10. All kinds of vehicles and other items may be parked or deposited in those areas specifically set aside for loading and unloading. Escape routes, fire brigade approach routes and fire brigade deployment areas must be kept free at all times. When depositing interchangeable open bodies or containers, measures must be taken to prevent them from sinking into the tarred surface. The owner / operator is liable for damage without proof of fault. Vehicles, containers, etc. which have been deposited illegally will be moved or towed away at the expense of the owner / keeper or perpetrator.

11. It is forbidden to act in any way which risks interrupting the regular progress of the event, the construction or the dismantling, or to violate the interests of ASG/Koelnmesse in any way. This includes the following in particular:

- every business activity not permitted on the trade fair grounds, in particular the sale of objects and services of all kinds or their distribution free of charge;
- the unauthorized distribution or posting of flyers, advertising material, posters, magazines etc. as well as the attachment of stickers of any kind; the same applies if the aforementioned material is distributed by Deutsche Post AG or comparable companies and organisations as bulk mailings or in similar fashion;

## Technical Guidelines

- the presence of animals;
- the pollution of the hall or outdoor areas as well as any behavior which could endanger or pollute the environment;
- the unauthorized entry of vehicles onto the trade fair grounds and the unauthorized use of vehicles on the trade fair grounds;
- the use of bicycles, scooters, kickboards, roller skates, inline skates, skateboards and similar means of transport on the Boulevard and in the halls, buildings and connecting levels; exceptions will be announced separately;
- unauthorized assemblies and processions of all kinds;
- the carrying of weapons and other objects which must be registered, or of hazardous substances and the like;
- the direct sale, purchase or exchange of exhibits and other objects – exceptions will be announced separately;
- being present at the trade fair grounds outside the opening hours.

12. Photography, filming, video recording, drawing, painting etc. for commercial purposes requires the prior written authorization of ASG/Koelnmesse and – in those cases involving stands or products belonging to exhibitors or other third parties, or concerning persons – the prior written permission of the holder of the rights. ASG/Koelnmesse has the right to impose more stringent regulations in this regard.

13. ASG/Koelnmesse staff or companies or persons working on behalf of ASG/Koelnmesse who take photographs, films, and/or record videos on the trade fair grounds in Cologne for the purpose of creating reports or advertising must not be disturbed or prevented from doing their work. All persons who enter the fair grounds and spend time there are informed by the house and ground regulations of the fact that photos will be taken and films and videos recorded on the trade fair grounds in Cologne. By entering the grounds, those people who can be identified in these photos or recordings consent to the use of this material for reports and for advertising purposes.

14. Surveys, statistical studies and other comparable reports are subject to prior written permission of ASG/Koelnmesse.

15. ASG/Koelnmesse has the right to limit the use of transmitting and receiving equipment on the trade fair grounds.

16. Exhibits, stand inventory or parts of display equipment and similar objects may only be transported within the trade fair halls or out of the fair grounds if the right to do so has been determined by the presentation of written confirmation from the owner / keeper.

17. Objects found on the trade fair grounds must be brought to the Lost and Found office located at Messewache (security office) North or East. Lost objects can be collected from this office.

Concluding regulations:

Should any person act in breach of these house regulations or any other provisions laid down by ASG/Koelnmesse, the latter reserve the right to evict that person from the trade fair grounds or bar that person from entering the grounds for a certain period or permanently. Breaches of the conditions of participation may result in exclusion from participation in the current event or from participation in future events. The measures listed in these house regulations do not exclude the possibility of criminal prosecution.

### 1.2 Opening Times

The opening hours vary from event to event. Please refer to the appropriate section of ANGA COM's exhibition conditions for more details.

#### 1.2.1 Construction and Dismantling Times

---

Refer to the appropriate section of ANGA COM's exhibition conditions for more details on construction and dismantling times.

Work may proceed in the halls and outdoor areas during the general construction and dismantling times. Exhibitors will be informed of special exceptions to these rules in good time.

#### 1.2.2 Duration of Event

---

Throughout the duration of the event, the halls are accessible for exhibitors one hour prior to the start of the trade fair and up to one hour after the closure of the trade fair.

Exhibitors who need to work on their stands outside these opening hours in justifiable individual cases must obtain special written permission to do so from ASG/Koelnmesse.

## **2 Traffic on the Fair Grounds, Escape Routes, Safety Equipment**

### **2.1 Traffic Regulations**

In order to ensure a smooth flow of traffic during the construction and dismantling period and for the duration of the event, it is important that various traffic control regulations are observed at all times. The instructions of the staff whose responsibility it is to control traffic must be followed and all corresponding information observed.

The provisions of the Road Traffic Regulations apply to the entire fair grounds and trade fair parking areas. The maximum permissible speed on the fair grounds is 30 km per hour. Illegally parked vehicles, lean-tos, containers, receptacles and empty containers of all kinds will be removed at the expense and risk of the owner.

ASG/Koelnmesse has commissioned a contracting company to manage the parking areas. Long-term parking permits for the use of trade fair parking areas by cars with insurance coverage can be ordered under "Parking permits" in the order media from ASG/Koelnmesse. The scope of this insurance coverage can be found in the printed conditions of the insurance company used by the security company.

Trucks, advertising vehicles, caravans and campers may not be parked in the trade fair parking areas. Parking spaces for trucks and caravans will be allocated on request.

For reasons of safety, motor vehicles may not be left in areas not specifically designated as parking spaces within the fair grounds on the days of the event. Vehicles which influence or impede the safety and smooth flow of traffic will be towed away at the risk and expense of the operator of the vehicle.

All indoor areas, detours and driveways directly adjacent to the halls must be cleared by 10.00 p.m. on the last construction day.

### **2.2 Escape Routes**

#### **2.2.1 Fire Department Operation Zones, Hydrants**

---

The necessary fire department approach routes (fire brigade access) and operation zones (deployment areas for the fire brigade) and those marked by no-stopping signs must be kept free for the fire department at all times. Vehicles and objects which are parked or deposited on the escape routes and safety areas will be removed at the cost and risk of the owner. Hydrants in the halls and in the outdoor areas may not be hidden, disguised or rendered inaccessible.

#### **2.2.2 Emergency Exits, Emergency Hatches, Hall Aisles**

---

The escape and rescue routes are to be kept clear at all times. It must be possible to open doors located along escape and rescue routes easily from the inside and they must open in their full width. The escape and rescue routes, exit doors and emergency hatches in the floors of the halls and their labelling are not allowed to be obstructed, blocked covered or defaced.

The escape and rescue routes in the halls are not to be restricted at any time by protruding objects that have been placed in the aisle.

In the case of violations, the exhibition company is entitled to find a remedy for the situation at the expense and risk of the perpetrator.

During the assembly and dismantling phase, it is permitted to briefly deposit materials needed for the assembly of the stand or exhibits delivered for immediate display at the exhibition space on the edge of the escape and rescue routes, as long as the aisle widths required for safety reasons are maintained and the logistic aspects are adequately taken into consideration.

These requirements are considered to be met if the deposited items take up a maximum of 0.9 m of space along the perimeter of the stand to the hall aisle.

Regardless of the width of the hall aisle and the deposited goods, a passage with a minimum of 1.2 m is to be left clear. Areas in front of emergency exits and the intersections of hall aisles are an exception to this rule and in these cases the full width must be kept clear at all times. It is not permitted to use the hall aisles for the construction of assembly areas or to deposit machines (e. g. woodworking machinery, workbenches, etc.).

At the request of the exhibition company, the immediate evacuation of all aisles can (also) be demanded for logistical reasons.

### **2.3 Safety Equipment**

Sprinkler systems, fire alarms, fire extinguishing equipment, smoke alarms, locking attachments for the hall doors and other safety equipment, the signs identifying them as such and green exit signs must be accessible and visible at all times. They may not be blocked

## Technical Guidelines

or hidden in any way. Fire protection equipment such as fireproof shutters may not be blocked at any time, nor may the construction be supported.

### 2.4 Stand Numeration

Every stand is given a number by the organizers. These stand numbers must be attached to each stand and visible to all for the duration of the event.

### 2.5 Security

ASG/Koelnmesse ensures a general watch on the trade fair halls and outdoor areas for the duration of the trade fair and during the construction and dismantling periods.

ASG/Koelnmesse has the right to take measures necessary for control and security. Where necessary, stand security must be organized by the exhibitor. Stand security personnel may only be hired from the security company commissioned by ASG/Koelnmesse.

### 2.6 Emergency Evacuation

For safety reasons, the trade fair company can order rooms or buildings to be evacuated and closed. All those who are present must comply with this instruction and gather outside. Exhibitors must inform their employees of this procedure, and, if necessary, organise and publicise their own evacuation procedures.

## 3 Technical Data and Equipment in the Halls and Outdoor Areas

### 3.1 Hall Data

Please read the instructions on the following pages.

#### 3.1.a Hall Overview

---

#### 3.1.b Hall Height (Clear Span)

---

#### 3.1.c Elevators

---

#### 3.1.d Service Doors / Fireproof Door Shutters, Smoke Aprons

---

#### 3.1.e Doors

---

#### 3.1.f Technical Hall Information

---

##### 3.1.1 General Lighting, Type of Power, Voltage

---

The general lighting in the halls measured 1 m above the hall floor is 300 Lux.

Type of power and voltage on the fair grounds:

Electrical supply:

1-phase alternating current 230 Volt (tolerance value in accordance with DIN EN 50160) / 50 Hz

3-phase alternating current 400 Volt (tolerance value in accordance with DIN EN 50160) / 50 Hz

##### 3.1.2 Compressed Air, Electrical and Water Supply

---

See section 3.1.f.

##### 3.1.3 Communications Facilities

---

Stands in all halls can be provided with telephone, fax, data and antenna connections.

## Technical Guidelines

### **Guidelines for the operation of exhibitor Wi-Fi networks at Koelnmesse:**

The operation of Wi-Fi networks by exhibitors is only permitted in trade fair halls. Operation outside of these halls and on the outdoor area is prohibited.

Only Wi-Fi networks in the 2.4 GHz range, based on the valid standards (802.11 b/g/n) with the channels 1, 5 or 9 may be operated. The operation of 5 GHz range requires a special permit through the organizer.

The transmitting power of your Wi-Fi transmitter may not exceed -80dBm at the border of the stand.

The SSID, i. e. the name of your access point, must consist of the hall number, the stand number and the company name (e. g. "H6 B45 companyname") and must be visible.

Channel bonding is not permitted. Only a channel width of 20 MHz is permitted (max. 72 Mbit/s with 802.11n).

Transmitters other than Wi-Fi transmitters are generally not permitted, as they can cause massive interference with the desired signals.

No Wi-Fi scanners or sniffers may be operated.

The general operation of Wi-Fi networks by exhibitors is only permitted in compliance with the above-mentioned guidelines and when the Wi-Fi operation has been registered at least 4 weeks before the start of the trade fair. You can find the form at [www.koelnmesse-service-portal.de](http://www.koelnmesse-service-portal.de).

NetCologne does not guarantee the operation of Wi-Fi networks for exhibitors.

NetCologne does not carry out any configurations on the Wi-Fi network of the exhibitor; the exhibitor is responsible for the orderly operation.

Networks which result in interference may not be operated. ASG/Koelnmesse and NetCologne reserve the right to switch off these networks.

Measures required to locate and eradicate "disruptive transmitters" or networks which have been set up incorrectly will be invoiced to the originator. The current invoicing rate is 60 EUR for each commenced half hour.

#### **3.1.4 Sprinkler Systems**

---

The trade fair halls are fitted with sprinkler systems.

#### **3.1.5 Heating, Ventilation**

---

Heating and ventilation is provided in all halls.

#### **3.1.6 Faults**

---

ASG/Koelnmesse must be informed immediately in the event of any faults occurring in the technical supply. ASG/Koelnmesse are not liable for loss or damage resulting from such faults unless at least grossly negligent behavior on the part of a legal representative or vicarious agent has occurred. In accordance with statutory obligations, ASG/Koelnmesse shall be liable for damages caused intentionally or by gross negligence in the event of any damage claims resulting from fatal injuries, bodily or health injuries.

### **3.2 Outdoor Areas**

Depending on the concept behind the event, the outdoor area may be used.



## Technical Guidelines

### 3.1.a Hall Overview

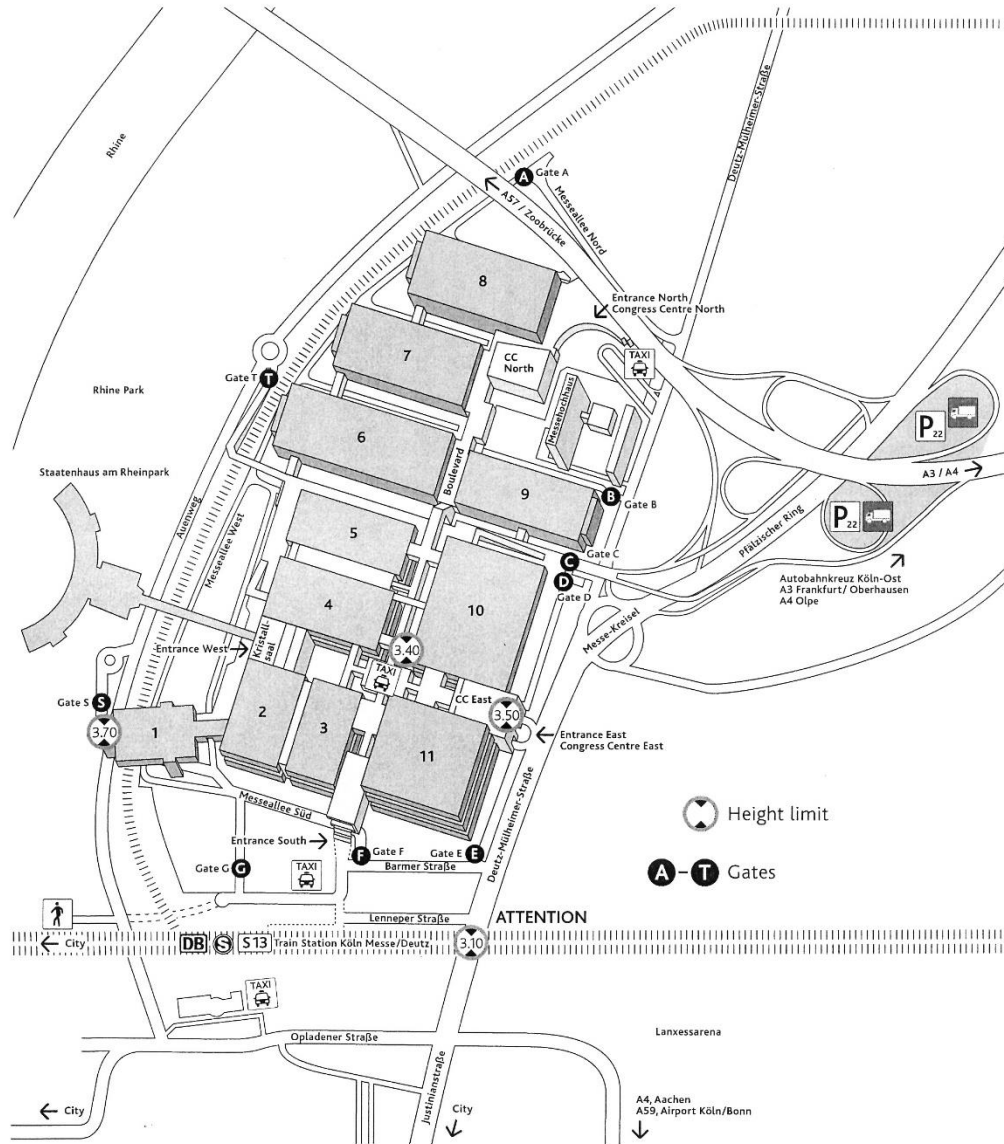

## Technical Guidelines

- 3.1.b Hall Height (Clear Span)  
Does not apply to stand superstructures

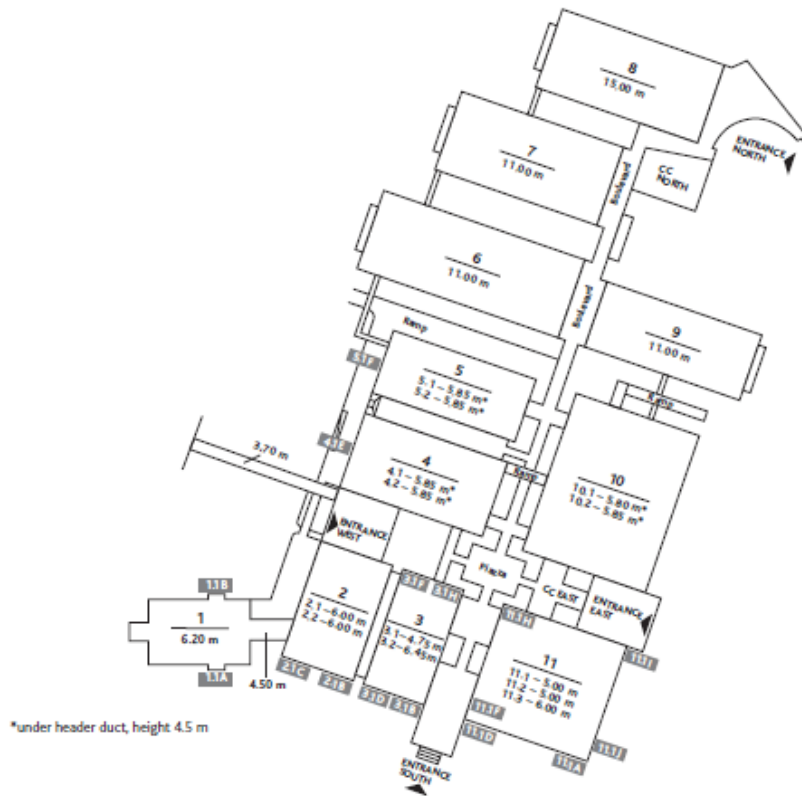

### 3.1.c Elevators

Hall	Elevator	Load carrying capacity	Dimensions			Hall	Elevator	Load carrying capacity	Dimensions		
			Width	Depth	Height				Width	Depth	Height
1.1	A	50 kN	2.90m	4.70m	2.75m	5.1	F	100 kN	2.30m	4.20m	2.90m
1.1	A	50 kN	2.90m	5.10m	2.75m	11.1	F,J	50 kN	2.45m	3.75m	2.65m
1.1	B	100 kN	3.40m	5.15m	2.75m	11.1	H	50 kN	2.35m	3.35m	2.65m
2.1	B,C	100 kN	2.30m	5.40m	2.85m	11.1	A,D	75 kN	3.35m	4.50m	2.90m
3.1	B,D,F,H	30 kN	2.80m	3.45m	2.10m	11.1	I	75 kN	5.50m	3.17m	2.65m
4.1	E	100 kN	2.60m	5.10m	2.85m						

Subject to alterations

01.02.2019

## Technical Guidelines

### 3.1.b Hall Height (Clear Span)

Does not apply to stand superstructures

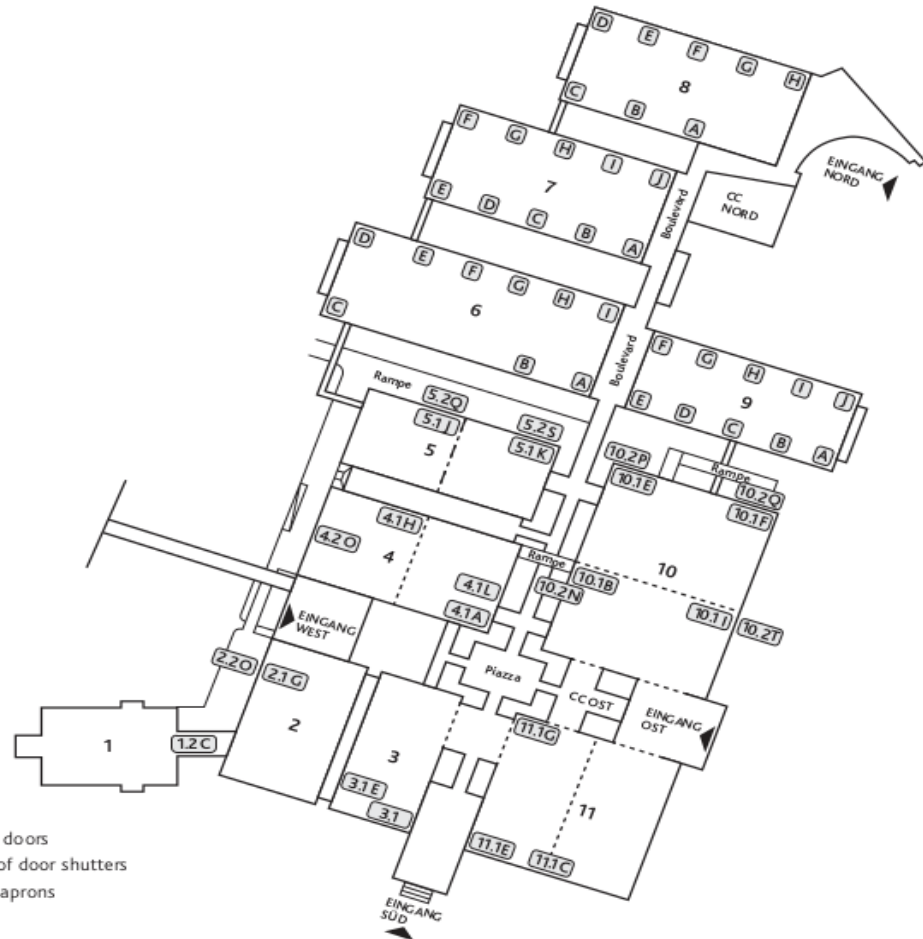

### 3.1.e Doors

Hall	Door	Dimensions	
		Width	Height
1.2	C	3.50 m	4.00 m
2.1	G	3.30 m	4.15 m
2.2	O	3.20 m	4.15 m
3.1		5.10 m	4.20 m
3.1	E	3.40 m	2.75 m
4.1	A	4.10 m	4.20 m
4.1	H	4.70 m	3.90 m
4.1	L	4.30 m	4.00 m
4.2	O	4.00 m	4.00 m
5.1	J, K	4.10 m	4.10 m
5.2	Q, S	4.10 m	4.10 m
6	D	6.00 m	6.00 m
6	A, B, C, E, F, G, H, I	6.00 m	4.50 m
7	F	6.00 m	6.00 m
7	A, B, C, D, E, G, H, I, J	6.00 m	4.50 m
8	D	6.00 m	6.00 m
8	A, B, C, E, F, G, H	6.00 m	4.50 m

Hall	Door	Dimensions	
		Width	Height
9	H	6.00 m	6.00 m
9	A, B, C, D, E, F, G, I, J	6.00 m	4.50 m
10.1	B	4.20 m	4.10 m
10.1	E	4.40 m	4.10 m
10.1	F	4.40 m	4.10 m
10.1	I	4.40 m	4.40 m
10.2	N	4.30 m	4.35 m
10.2	P	4.35 m	4.30 m
10.2	Q	4.35 m	4.30 m
10.2	T	4.30 m	4.35 m
11.1	C	3.10 m	3.40 m
11.1	E	5.20 m	2.60 m
11.1	G	3.50 m	2.70 m

Subject to alterations

## Technical Guidelines

### 3.1.f Technical Hall Information

Hall	Permissible load in kN per m <sup>2</sup> area	Supply points	Water supply points	Compressed air supply points	Steam supply points	Exhaust gas facilities	Antenna connections	Sprinkler system	Parking areas/ parking levels
1	10	■	■			■	■	■	
2.1	20	■	■	■		■	■	■	
2.2	20	■	■	■		■	■	■	1
P.2-3	5	■					■	■	
3.1	20	■	■	■		■	■	■	
3.2	10	■	■	■		■	■	■	
P.3-4	5	■					■	■	
P.3-11	5	■	■				■	■	
4.1	20	■	■	■		■	■	■	
4.2	20	■	■	■		■	■	■	2
P.4-5	5	■						■	
P.4-10	5	■	■				■	■	
5.1	20	■	■	■		■	■	■	
5.2	20	■	■	■		■	■	■	2
P.5-10	5	■						■	
6	50	■	■	■	*	**	■	■	
7	50	■	■	■	*	**	■	■	
8	50	■	■	■	*	**	■	■	
9	50	■	■	■	*	**	■	■	
10.1	20	■	■	■	■ East	■	■	■	
10.2	20	■	■	■		■	■	■	1
11.1	20	■	■	■	■ Middle	■	■	■	
11.2	15	■	■	■	■ South	■	■	■	
11.3	7,5	■	■	■		■	■	■	1
Boulevard ***	5	■	■				■	■	

- \* Steam supply points on request
- \*\* Exhaust gas system on request
- \*\*\* Forklift trucks are strictly prohibited. Pallet jacks and other industrial trucks must be fitted with light-coloured plastic wheels. Steel wheels and black rubber wheels are not permitted. The floor must be protected against soiling by laying canvas, cover panels or similar underneath the cargo. Soiling must be completely removed without delay. Soiling or damage must be reported immediately to the technical service team or the facility manager.

Subject to alterations

## **4 Stand Construction Regulations**

### **4.1 Stand Construction Safety**

Exhibition stands including equipment, exhibits and advertising material must be erected in such a stable manner as to avoid endangering life and limb as well as public safety and order.

The stand's stability must be ensured during all phases of the event (construction, the event itself, dismantling).

The exhibitor is responsible for the structural and transport safety of the exhibition stand and may be asked to provide proof thereof. This applies to the construction and dismantling times as well as to the event itself.

To ensure the stability of the stands, a horizontal equivalent distributed load of 0.125 KN per m<sup>2</sup> should be used to maintain sufficient stability against sliding and overturning. Deviations are possible in justifiable individual cases, following consultation with ASG/Koelnmesse. If the case justifies it, ASG/Koelnmesse reserves the right to have a structural engineer evaluate the stand's stability on site for a fee. This also applies after a stand construction authorisation has already been issued.

Vertical construction elements and/or special constructions (e.g. free-standing walls, high exhibits, high decorative elements) which could fall over must be able to withstand a horizontally acting equivalent distributed load  $q_n$ , where:

$q_{n1} = 0.125 \text{ kN/m}^2$  up to a height of 4 m above floor level

$q_{n2} = 0.063 \text{ kN/m}^2$  for all areas above a height of 4 m above floor level.

The area to be considered for this purpose is the projection of the actual surface onto the vertical plane (elevation). The documentation of these measurements must be available for inspection upon request by the trade fair company.

DIN 4102 (behaviour in case of fire of construction materials, components) or EN 13501-1 must be observed and complied with.

### **4.2 Stand Construction Authorization**

Assuming that the technical guidelines are observed when designing and erecting stands, there is no need to submit for approval drawings for one-story stands in the halls. Stands with a size of 50 sqm or more, however, need to be approved in terms of design aspects. For these stands true-to-scale drawings including an isometric view have to be submitted to ASG/Koelnmesse six weeks before the show at the latest.

All other stands, mobile stands, special constructions and superstructures must be approved.

#### **4.2.1 Inspection and Acceptance of Constructions which Require a Permit**

Dimensioned stand plans in German language on a scale of at least 1:100 with plans and elevations must be submitted for approval to ASG/Koelnmesse in duplicate at least six weeks before the start of construction.

One copy of the stand plan is returned to the exhibitor/stand constructor with an "approved" endorsement once it has been checked. Construction of the stand may only commence after this "approved" endorsement has been granted.

For the approval of

- special constructions
- cinema space or auditoriums
- outdoor constructions
- stage area
- temporary constructions

the following documentation (in duplicate) must be submitted in German at least six weeks before the start of construction:

- a) tested structural (static) calculations in accordance with German standards
- b) a description of the construction and
- c) stand constructional drawings on a scale of 1:100 (plans, elevations, sections), construction details on a larger scale.
- d) Points a) and b) do not apply in cases where a type verification and tests / inspect and test log book can be provided.

The cost of the building permit procedure will be invoiced to the exhibitor / stand constructor.

## Technical Guidelines

### 4.2.2 Vehicles, Containers and Tents

---

Permission has to be obtained for the parking or erection of vehicles, trailers, containers, refuse containers, tents etc. For a fee, a reservation for a parking spot can be applied for in the logistic zone outside the halls for vehicles, trailers, containers, refuse containers, etc. using the order form T.20. This form can be found in the ASG/Koelnmesse Service Portal (KSP).

Depending on the usage, state and location, it may be necessary to have vehicles, containers, and tents, etc. left inside and outside the halls equipped with fire extinguishers and fire detectors (which are connected to the fire alarm system of Koelnmesse and that of the Cologne fire department).

### 4.2.3 Modifications to non-regulation Components

---

Stand constructions which have not been approved and/or do not comply with the technical guidelines or legal provisions may have to be altered or removed.

If these changes are not completed within the time stipulated by ASG/Koelnmesse, the latter has the right to make these changes itself at the expense of the exhibitor.

The partial or complete closure of a stand may also be ordered should important grounds, especially serious safety deficits, exist.

## 4.3 Overall Height

Details on the official stand height at ANGA COM are contained in the Exhibition Conditions.

All outer walls and other parts of stand constructions facing neighbouring stands must be neutral (white and clean) above a height of 2.5 m.

## 4.4 Fire and Safety Regulations

### 4.4.1 Fire Protection

---

#### 4.4.1.1 Stand Construction and Decoration Materials

---

Generally, no easily flammable, burning droplets or toxic gases and materials with a strong smoke formation such as poly-styrene hard foam (Styrofoam) or any similar materials are allowed to be used. This applies equally for the stand construction and for decoration materials.

Furthermore, in individual cases special stipulations may apply for the load-bearing structural elements (i. e. non-flammable) for reasons of safety.

In addition to the above-mentioned characteristics, decoration material has to be classed at least as flame retardant (Class B1) in accordance with DIN 4102 and have a low smoke generation or at least fall under Class C-s2, d0 in accordance with EN 13501-1. A test certificate on the building material class of the implemented material may be requested.

In individual cases, normally flammable and/or decoration material with burning droplets are allowed to be used if

- these are sufficiently protected against flammability due to the corresponding installation, or
- these are only implemented in low quantities or in positions where no fire/safety risk exists.

The testing and approval of the respective installation situation is exclusively carried out by the trade fair organization and upon prior written notification about the planned installation of these materials. The required documents (i. e. on the installation situation or the fire protection classes) must be attached. As a rule, bamboo, reed, hay, straw, bark mulch, peat or similar materials do not comply with the above-mentioned requirements and in general have to be protected separately or the necessary fire protection measures have to be carried out. Foliage and conifers are only allowed to be implemented if their roots are moist.

The implementation of plastic cable straps to fasten statically stressed parts is prohibited.

#### 4.4.1.2 Display of Motor Vehicles

---

Display in the exhibition halls: Vehicles with combustion engines may only have enough fuel in their tanks to drive into and out of the facility (the fuel reserve warning light must be on in the display). The fuel tank must be locked.

If vehicles are presented in other building areas, additional safety measures may be required, including the inerting of tanks, the disconnection of batteries and/or the use of security guards.

## Technical Guidelines

### 4.4.1.3 Explosive Substances / Munitions

---

Explosive substances are subject to the respective valid version of the Explosives Act and may not be used or exhibited at trade fairs and exhibitions. This also applies to ammunition within the sense of the Weapons Act.

### 4.4.1.4 Pyrotechnics

---

Regardless of and subject to the granting of an official permit (Office of Public Order of the City of Cologne, Tel.: +49 221 221-0), the written consent of ASG/Koelnmesse has to be obtained in advance for pyrotechnic presentations.

Proof of the license holder and the certificate of competence have to be presented. In order for the permit to be issued, details on the place and time of the presentation, the number and type of the pyrotechnic effects, the registration numbers of the fireworks (BAM/German Federal Institute for Materials Research & Testing), the duration of the pyrotechnic effects, the required safety distance as well as a risk assessment have to be provided. The required documents have to be submitted in due time, however at least 14 days before the presentation. The trade fair exhibitor has no entitlement to be granted a permit.

### 4.4.1.5 Use of Balloons and Flying Objects

---

The use of safety-gas-filled balloons and other flying objects in the halls and outdoor areas must be approved by ASG/Koelnmesse.

### 4.4.1.6 Fog Machines

---

The use of fog machines is not permitted.

### 4.4.1.7 Smoking in the Halls

---

Smoking is prohibited in the exhibition halls and the boulevard area.

### 4.4.1.8 Recycling Containers, Non-Recyclable Trash Containers

---

Recycling containers and non-recyclable trash containers made of flammable material may not be used at the stands. Recycling containers and non-recyclable trash containers at the stands must be emptied regularly and at least every evening once the trade fair has ended for the day. Should larger amounts of inflammable refuse accumulate, these must be disposed of several times a day.

### 4.4.1.9 Spraying Guns, Solvent-based paints

---

The use of spray guns as well as the implementation of solvent-based paints is forbidden. Furthermore, it is not permitted to release solvent-based substances/liquids into the sewer or wastewater system of Koelnmesse (see also 6.2.1).

### 4.4.1.10 Abrasive Cutting and Grinding Work and All Work / Demonstrations / Displays with Open Flames, Fire-places and Fire Loads

---

Welding, cutting, soldering, grinding and separating work as well as other work with open flames or flying sparks is prohibited in the exhibition area and on the company grounds of ASG/Koelnmesse.

In exceptional cases a permit for flame work with special safety conditions (permit for work involving an increased risk of fire) can be issued by the Exhibition Technology Department upon written request.

The presentation of exhibits involving open flames as well as performances involving open flames, fireplaces and fire loads have to be registered with ASG/Koelnmesse at least six (6) weeks prior to the start of the event.

E-mail: [Safety@koelnmesse.de](mailto:Safety@koelnmesse.de)

The following are subject to registration:

- a) The operation of all types of fireplaces, i.e. fires with chimneys, torches, radiant heaters, candles (even inside a glass), grills (gas or coal-driven). Fireplaces that serve purely for decoration purposes are not permitted in the exhibition halls.
- b) The introduction of larger volumes of fire loads (i.e. firelighters, charcoal, bioethanol, etc.)

Attention: The operation of non-registered fireplaces is prohibited, this also applies for the introduction of high fire loads.

If the exhibition, presentation and operation of fireplaces or the introduction of fire loads is permitted, ASG/Koelnmesse will lay down the necessary framework conditions and inform the respective party in writing.

## Technical Guidelines

### 4.4.1.11 Empty Containers

---

It is forbidden to store empty containers of all kinds (e.g. packaging and package materials) at the stands and outside the stands in the hall. All empty containers must be removed immediately.

The contract carrier of ASG/Koelnmesse offers storage options.

### 4.4.1.12 Fire Extinguishers

---

ASG suggests keeping suitable and tested fire extinguishers on hand at the stand. Please note that stands with a high content of flammable materials must have a fire extinguisher available. Exclusively foam extinguishers are allowed to be used. Powder extinguishers are necessary for presentations with flammable gases.

Fire extinguishers suitable for extinguishing burning fat must be available in kitchen areas. Please complete and return the appropriate order form to hire fire extinguishers.

### 4.4.2 Stand Covering

---

To prevent the sprinkler system from being inhibited, exhibition stands must be open at the top. Closed stand coverings, also in part, are not allowed.

Ceilings are considered to be open if horizontally a maximum of 50 percent of the ceiling area as calculated for every individual square metre of the ceiling area is closed (if ceilings are tilted, this is calculated on the basis of the horizontally projected area covered by the ceiling.).

A valid certificate from an approved inspection office regarding fire resistance (B1 according to DIN 4102 or Class EN 13501-1, at least Class c-s2, d0) and sprinkler suitability must be submitted. The opening of the material must measure at least 2x4 mm or 3x3 mm (interior dimensions) in a non-stretched state. Alternatively, the system's sprinkler suitability (heat and water permeability) can be demonstrated with a VdS certificate. It must be ensured that the span fabrics that are used are installed horizontally and in one layer. The span fabrics can be stretched across individual fields measuring up to 30 square metres with out requiring any additional measures. Fields that exceed this size have to be supported by additional construction measures.

### 4.4.3 Glass and Acrylic Glass

---

Only safety glass is permissible. The edges of the glass panes must be worked or protected in such a manner that there is no danger of injury. Components made wholly of glass must be marked at eye level.

In the case of structures made of glass, the requirements listed in the "Glass in Stand Construction" information sheet (which can be ordered from ASG) must be adhered to.

### 4.4.4 Meeting Places

---

All rooms that are enclosed on all sides (closed rooms) and have no visual or acoustic connection with the hall must be fitted with a visual and acoustic warning system to ensure that alarm signals may be received at the stand at all times. Exceptions are possible subject to approval.

## 4.5 Exits, Escape Routes, Doors

### 4.5.1 Exits and Escape Routes

---

Stand areas that cover more than 100 m<sup>2</sup> or do not have a clear layout must have at least two separate exits / escape routes that are located opposite one another (Special Construction Regulation Part 1: Assembly Areas §6 SbauVO).

The distance from any point of an exhibition space to a hall gangway may not exceed 20 metres (in accordance with Special Construction Regulation Part 1: Assembly Areas §7 SbauVO).

The emergency exits and escape routes have to be marked as such in accordance with DGUV V9.

### 4.5.2 Doors

---

It is not permissible to use swinging doors, revolving doors, code-operated doors or sliding doors at emergency exits or escape routes.



## Technical Guidelines

### 4.6 Platforms, Ladders, Steps, Catwalks and Ramps

Generally accessible areas that directly border areas that are more than 0.20 metres lower are to be surrounded by railings. These have to be at least 1.10 metres high and have horizontal load resistance on the handrail of 1.0 kN per running metre. They have to be equipped with at least one upper chord, one middle chord and one lower chord.

A statics certificate has to be presented for the platform. Depending on the use to which it is put, the floor must be able to support at least 2.0 kN/m<sup>2</sup> in accordance with DIN EN 1990-12, sheet 3, if used for an office or consulting space, and at least 5.0 kN/m<sup>2</sup> if used for an exhibition space. Platforms which are to be reached by taking only one step may not be more than 0.19 metres high.

It is not permissible to place steps in main or secondary gangways or necessary passageways. It is permissible to have three or more stairs placed after each other if they have stair lighting as well as lighting from above, and if the stair lighting is connected to the security lighting.

The gradient of the ramps is not allowed to exceed 6 %.

Ladders, steps and catwalks must be in accordance with accident prevention regulations.

### 4.7 Stand Design, Walls

#### 4.7.1 Appearance

---

The exhibitors are responsible for the design of their stands.

Closed walls that are adjacent to visitor corridors need to be approved by ASG.

The backs of stands that are adjacent to other stands must be kept neutral above a height of 2.5 m (white and clean) so that they do not interfere with the design of the neighbouring stands.

#### 4.7.2 Checking of the Rented Area

---

The rented area is marked by ASG/Koelnmesse.

The local markings shown at the rented area are the only ones valid for stand location, layout and dimensions as well as for any built-in units.

The stand boundaries must be adhered to.

#### 4.7.3 Changes to the Substance of the Building

---

The various parts of the halls and the technical equipment may not be damaged, soiled or changed in any other way (e.g. drilling, nailing, and screwing). In addition, the building and its parts may not be painted, decorated with wallpaper or glued.

The halls, their parts and the technical equipment may not be impaired in any way by stand superstructures or exhibits.

It is permitted to enclose the columns and supports of the halls within the stand areas as long as the columns / supports are not damaged and the height regulations are adhered to.

#### 4.7.4 Hall Flooring

---

Rugs and other floor coverings may not project beyond stand boundaries and must be laid out in such a way that accidents cannot occur. Only adhesive tape that can be removed without leaving any residue may be used to affix objects.

All materials must be removed without leaving any residue. This also applies to substances such as oil, grease, paint etc.

The floor of the halls may neither be painted nor glued. Anchorages or fastenings are not permitted.

#### 4.7.5 Hanging Objects from the Hall Ceiling

---

Objects may only be hung from the hall ceiling at the fittings intended for this purpose and may only be hung up by ASG/Koelnmesse's contractual partners. The mounting equipment provided for this purpose must be used and may not be removed. Ceilings, advertising materials, banners, lighting elements, and similar objects may be hung vertically from the supporting structure of the hall ceilings in compliance with the regulations concerning the building height and permissible loads on Form T.03. With regard to attaching the objects to be hung, the relevant safety regulations must be observed, especially DGUV V1 (General Regulations), DGUV V17 (Event and Production Facilities for Scenic Presentations), DGUV V54 (Jacks, Lifting and Pulling Equipment) and the Special Construction Regulation Part 1: Assembly Areas (SbauVO).

## Technical Guidelines

Elements that are intended to stand on the floor must be manufactured in a way that allows them to stand in a stable manner. Elements that require suspension devices for such stability are not permitted. Projecting parts of constructions that stand in a stable manner on the floor are permitted to be hung from the hall ceiling.

The material (beam carriers, etc.), cables, and fastening devices used on their own responsibility by exhibitors or by companies commissioned by the exhibitors must comply with the valid regulations and must be free of defects.

### 4.7.6 Stand Partition Walls / System Stands

---

ASG/Koelnmesse generally does not use walls to demarcate the area rented by the exhibitor.

Those exhibitors wishing to use partition walls for their stands can order them from ASG/Koelnmesse. These walls are 250 cm high and approx. 100 cm wide, with a white, scratch-resistant plastic surface. They may not be painted, glued, nailed or otherwise damaged in any way. In the event of damage, a replacement fee of € 300 per wall element will be invoiced to the exhibitor. For a surcharge, the partition walls are available with coloured coatings. All graphics or similar items affixed by the exhibitor must be fully removed after the event, without damaging the walls or leaving any residue on the walls.

Shelves and other furnishings may not be attached to the partition walls.

System stands can be obtained from ASG/Koelnmesse. Detailed information can be found in the appropriate forms.

If ordered on time, the stand or the stand partition walls can be accepted and occupied 24 hours prior to the start of the trade fair. Occupation at an earlier time requires written agreement. The structures erected by ASG/Koelnmesse may not be altered. ASG/Koelnmesse do not guarantee the stability or safety of the framework structure if construction elements are damaged or disassembled in any way.

The exhibitor is personally liable for arbitrary changes and resulting damages to stand structures carried out by themselves or by third parties under commission.

Due to personal liability considerations, exhibitors are strongly advised to suitably insure the rented property.

The system stands and the stand partition walls are dismantled immediately after the end of the event. All items belonging to exhibitors must therefore be taken away once the trade fair is over. If any items, particularly food, beverages, and tobacco, are found after the trade fair is over, it will be assumed that the exhibitor or other person has relinquished ownership of these items. Items that are especially marked in a manner clearly recognizable to third parties are not subject to this regulation. ASG/Koelnmesse is not liable within the limits imposed by law for loss or damage as long as intention or gross negligence cannot be proven.

### 4.7.7 Advertising / Presentations / Outdoor Advertising

---

Stand and exhibit labels as well as company trademarks and brand names may not exceed the prescribed height.

Acoustic and visual presentations must be approved by ASG/Koelnmesse. The permit is issued under the condition that the sound volume will not exceed 70 decibels and the presentation does not interfere with work at the neighboring stands in any way. In order to avoid the disturbance of neighbouring stands by optical and/or acoustical presentations, any presentation has to be agreed upon with the staff of the neighbouring stands.

If these regulations are repeatedly violated, the power supply to the exhibitor's stand can be interrupted regardless of the effect on the stand as a whole. The exhibitor is not entitled to compensation for any damage suffered directly or indirectly due to the interruption in the power supply. The burden of proof of compliance with the regulations lies with the exhibitor.

Printed material and advertising may only be distributed in the exhibitor's own stand area.

Advertising space within the exhibition grounds is let exclusively by ASG/Koelnmesse.

Upon request, ASG/Koelnmesse will provide the necessary advertising spaces for a rental fee and will take care of the professional design of your advertising. ASG/Koelnmesse will mount the advertisements if commissioned to do so. The booking of advertising spaces must be made at the latest six weeks before the event commences. Should exhibitors provide their own advertising facilities, or such as have been specially made for them, then these must conform to fire, structural and safety requirements and must in their design be in keeping with the standards as laid down for exhibition advertising by the ASG/Koelnmesse. The deadlines set by the ASG/Koelnmesse for the delivery and collection of such advertisement facilities must be strictly observed.

For reasons of technical safety, punctual observance of time schedules and liability in case of damage, the ASG/Koelnmesse is exclusively responsible for the installation, assembly and dismantling of advertisement facilities.

After confirmation of your order you will receive an invoice from the ASG/Koelnmesse concerning its services (hire charge for advertising space, allocation of advertisement facilities, costs of the assembly and dismantling work and the

## Technical Guidelines

design and/or the creation of the advertising message). This invoice is to be settled in full, without deductions of any kind, at the latest 10 weeks prior to the beginning of the event. After this date made out invoices become due immediately and payable in full without any deduction. Objections of any kind in respect of the invoice must be made within one week of receipt of the said invoice. Complaints received after this date cannot be considered.

### 4.7.8 Barrier-free access

---

The design of the stands should enable barrier-free access. People with disabilities should be able to access and use the stands and their facilities without outside help.

### 4.8 Outdoor Areas

Information on the technical conditions can be requested from ASG/Koelnmesse.

### 4.9 Two-Story Construction

Two-story construction is not allowed.

## 5 Operational Safety, Technical Safety Regulations, Technical Code, Technical Supply

### 5.1 General Regulations

Construction and dismantling work may only be carried out if it is in compliance with valid labor and industrial law regulations.

#### 5.1.1 Damages

---

Damage to the fair grounds, buildings or parts of the buildings caused by exhibitors or their authorized representatives must be reported to the appropriate persons, i.e. Messewache (security office) North or East and hall inspector offices. The damages will be repaired by ASG/Koelnmesse after the end of the event at the expense of the exhibitors involved.

### 5.2 Use of Tools

The use of explosive-actuated guns is prohibited.

The use of woodworking machines without dust extraction is not permissible. The regulations contained in the currently valid Operational Safety Ordinance (BetrSichV) must be adhered to.

### 5.3 Electrical Installation

#### 5.3.1 Connections

---

Those stands which require a supply of electric power will be given one or more connections if these have been ordered. The connections will be supplied exclusively by the electrical company officially contracted by ASG/Koelnmesse.

The order must be sent without delay, and at the latest four weeks prior to the start of the event. A sketched plan clearly indicating the desired location of the connections must be enclosed with the order form for electrical installations. The installation company will invoice the exhibitors for the costs of installing the wiring system in accordance with the details in the bill of delivery and assembly. The timely completion of all connections can only be assured if exact documentation such as sketched circuit diagrams, connection values, location of the connections etc. are submitted at least four weeks before the start of the event. An expert will conduct an acceptance inspection prior to the event. Complaints about deficiencies may be made during the event only.

For safety reasons the power supply is generally cut one hour after the trade fair has ended on the last day of the event. Should parts of the wires etc. be missing after dismantling, the exhibitors will be asked to pay the full price for their replacement.

It is prohibited to remove the fixed electrical connections or lighting systems in the exhibition halls. Fixed installation connections in the allocated stand area may, where necessary, also be put at the disposal of neighbouring stands. Prior to the allocation of an installation order, each exhibitor must contact ASG/Koelnmesse to obtain information on the possibility of being connected to the hall supply. In its capacity as central consumer, ASG/Koelnmesse will supply the exhibitors with the electric power required for the connections they have registered. The costs will be invoiced together with the stand rent as a specific power-cost flat rate per square metre. As part of a special regulation, ASG/Koelnmesse reserves the right to draw up individual invoices for large consumers by metering the amount of power they have consumed. Exhibitors who wish to have their power consumption measured and receive a separate invoice can apply to have a

## Technical Guidelines

meter installed at their own expense. The stands are supplied with electricity via TN-C-S with a nominal voltage of 230 V +6% -10% 50 Hz for alternating current and 400 V +6% -10% 50 Hz for three-phase current. Campers and caravans in the outdoor area are supplied with electricity via a three-pole 230 V/16A earthed socket in accordance with DIN 49462 (concentric plug-and-socket). Each camper/caravan is connected individually to the power supply via a socket with a series connected earth leakage protection (breaking current 30 mA). To connect campers/caravans, the following are required: a connecting line, a HO7 RN-F 3 G, 1.5 rubber-insulated flexible cable in accordance with VDE 0282, component 810 with concentric plug-and-socket, degree of protection IP 44, length 20.00 m. It is not permitted to connect more than one camper/caravan to the power supply via socket.

### 5.3.2 Stand Installation

---

All installations within the stand area must be in accordance with the currently valid IEC and VDE stipulations (see item 5.3.3). The TN-S network must be used at the stand. It must be possible to isolate every stand from the hall power supply via a main switch or, if permissible, a plug-and-socket connection. If electricity is needed without interruption for certain devices, e.g. refrigerators, computers etc., a separate circuit must be set up in front of the main switch. This circuit must remain powered once the main switch has been switched off. Earth leakage protection is required as a protective measure. At the stands, electrical installations may be made either by the exhibitors' own electricians or by specialist electrical companies which have been authorized in accordance with VDE and internationally valid regulations and standards and which operate according to the state of the art. Before the stands are connected to the hall supply network, the electrical installations must be inspected by the expert commissioned by ASG/Koelnmesse. Should the valid regulations not be met, ASG is obliged to refuse connection to the supply network. The exhibitor is liable for the costs of correct installation and further inspections. If stand installations need to be subsequently modified, the exhibitor assumes responsibility.

### 5.3.3 Assembly and Operating Regulations

---

All electrical systems must be installed in compliance with the latest VDE safety regulations, particularly DIN VDE 0100, 0108, 0128, 0100-560, 0100-718, DIN EN 50172.

The share of high or low frequencies emitted into the mains as interference may not exceed the values given in VDE 0160 and VDE 0838 (EN 50 006).

Conductive components must be included in measures taken to protect against indirect contact.

Only cables and wires that meet VDE standards may be used. No flat cables of any kind are permitted. Plain (uninsulated) cables terminals and conductive components that are not contact-protected are forbidden. The same applies for low-voltage systems. The secondary circuits must be protected against short circuiting and overload. After the end of each day of the fair the exhibitors must cut off their stands from the hall supply.

### 5.3.4 Safety Measures

---

As a means of special protection, all heat-generating and heat-developing electrical appliances (hot plates, projectors, transformers etc.) must be mounted on non-flammable, heat-resistant, asbestos-free bases. Depending on the heat generation in each case, sufficient clearance from flammable materials must be ensured. Lighting fixtures may not be attached to flammable decorations or similar. UV-B and UV-C rays may be used only for the operation of certain devices.

### 5.3.5 Safety Lighting

---

Stands for which the existing general safety lighting is not effective as a result of the structure of the stand require additional safety lighting in compliance with DIN VDE 0100-560, 0100-718, DIN EN 50172. It must be laid out in such a manner that ensures safe passage and guidance to the general escape routes.

## 5.4 Water and Waste Water Installation

Each stand which requires water / waste water facilities will be given one or more connections if these have been ordered with the corresponding order form.

Fixed installation connections in the allocated stand area may, where necessary, also be put at the disposal of neighbouring stands if this is possible without affecting the stand construction. Prior to the allocation of an installation order, each exhibitor must contact ASG/Koelnmesse to obtain information on the possibility of being connected to the hall supply.

The order form must be submitted without delay, and at the latest four weeks prior to the start of the event. The costs of installation will be invoiced by ASG/Koelnmesse to the exhibitors in accordance with the details in the bill of delivery and assembly. In its capacity as central consumer, ASG/Koelnmesse will supply the exhibitors with the water required for the connections they registered at a minimum

## Technical Guidelines

pressure of 2 bars and a maximum pressure of 6 bars. A special request must be made to ASG/Koelnmesse if larger amounts are required.

The water pipes leading from the supply points in the halls to the exhibitors' stands may only be laid by installation companies authorized to do so by ASG/Koelnmesse.

The pipe material will be provided by the installers for the duration of the event for a usage fee. Should parts of the wires or armatures be missing after dismantling, the exhibitors will be asked to pay the full price for their replacement. The installation must comply with valid technology regulations. Complaints about deficiencies may only be made during the event. A sketched plan which clearly indicates the desired location of the connections must be attached to the order form.

For safety reasons, the water supply on the last day of the trade fair is generally cut one hour after the trade fair has ended.

### 5.5 Compressed Air Installation / Gas Installation

#### 5.5.1 Compressed Air

---

For details of the supply of compressed air from the Koelnmesse supply, see 3.1.f.

Compressed air connections can be ordered using the corresponding order media from ASG/Koelnmesse. The costs of installation will be invoiced by ASG/Koelnmesse to the exhibitors in accordance with the details in the bill of delivery and assembly. The corresponding legal regulations and provisions must be adhered to in those cases where exhibitors wish to use their own compressed air tanks.

The noise emitted by the compressed air tank may not exceed 70 dB (A) at the stand boundary.

The installation must comply with valid technology regulations.

#### 5.5.2 Gas

---

Gas cannot be provided from the Koelnmesse hall supply.

Instructions and guidelines for the use of gases are contained in 5.7.

### 5.6 Machine, Pressure Vessel, Exhaust Gas Facilities

#### 5.6.1 Machine Noise

---

The use of loud machines and devices should be kept to a minimum out of consideration for the other exhibitors and the visitors. The volume may not exceed 70 dB(A) at the edge of the stand. The relevant project director can notify you of the permitted machine demonstration times on request.

#### 5.6.2 Product Safety Law

---

In accordance with Article 3 of the "Gesetz über technische Arbeitsmittel und Verbraucherprodukte" (Product Safety Law ProdSG), products (technical tools and consumer products) may only be marketed if they comply with the requirements of the ProdSG or regulations based on this law. Equal importance is attached to importing products into the European Economic Community and placing new products on the market.

If the respective product requires a CE certification, the exhibitor must keep the following documents at the stand as proof: the EC declaration of conformity and/or the declaration of the manufacturer and the instruction manual.

The aforementioned regulations apply for medical products in accordance with the Medizinprodukte-Gesetz MPG (Medical Products Law).

For further information, please contact Bezirksregierung Köln Zeughausstraße 2-10, 50667 Köln, Germany.

Products according to the ProdSG or medical products in accordance with the MPG may be set up and presented for advertising purposes, even if they do not meet the requirements of Article 3 of the ProdSG or Articles 6 and 10 of the MPG.

A precondition here is that a visible sign is present and marked according to Article 3 Par. 5 of the ProdSG or Article 12 Par. 4 of the MPG.

During presentations of products, the staff at the stand must take the necessary measures for the protection of persons. They are also responsible for ensuring that devices are not switched on by unauthorised persons.

## Technical Guidelines

### 5.6.2.1 Safety Devices

---

Machine and appliance components may only be operated if all safety devices are activated.

The normal safety devices can be replaced by a safe covering made of organic glass or similar transparent materials.

If the machines are not in operation, the safety devices can be removed to allow visitors insight into the construction and design of the uncovered components. In this case, the safety devices have to be placed next to the machine and be clearly visible.

### 5.6.2.2 Test Procedures

---

For each trade fair, the technical tools on display will be inspected by the responsible supervisory authority (State Authority for Industrial Safety) as to their compliance with safety and accident prevention regulations. If necessary, this will be undertaken in conjunction with the responsible expert committees from the employers' liability insurance associations. The EC declaration of conformity must be kept at the trade fair stand to allow the authority to check the CE certification. In cases of doubt, the exhibitor should contact the responsible authority in good time before the start of the trade fair.

Information regarding the Equipment Safety Law is provided by the Staatliches Amt für Arbeitsschutz, Schanzenstr. 38, D-51063 Cologne, Germany, phone: +49 221 962770.

Exhibitors should also seek consultation regarding the safety of their technical devices in good time before the trade fair begins, e.g. from the Prüfstelle für Gerätesicherheit des TÜV-Rheinland, Am Grauen Stein / Konstantin-Wille-Straße 1, 51105 Cologne (Poll), Germany.

### 5.6.2.3 Operating Ban

---

In addition, ASG/Koelnmesse has the right to ban the use of machines, appliances and devices if it is of the opinion that their operation could endanger persons or objects.

If serious violations of safety regulations for technical devices are found, the responsible authorities can, according to Article 5 of the Equipment Safety Law, ban the machines, appliances or devices in question from being exhibited.

Violating such a ban is a legal offense that can be punished with a fine.

## 5.6.3 Pressure Vessels

---

### 5.6.3.1 Approval Confirmation

---

Pressure vessels may only be operated at the stand if they have been tested according to the currently valid version of the Operational Safety Ordinance (BetrSichV).

The corresponding proof of testing is to be kept at the exhibition location next to the pressure vessels and presented to the responsible authority upon request.

### 5.6.3.2 Testing

---

The certification of design pressure and water pressure testing is not sufficient. This requirement also applies to foreign and borrowed containers. If the exhibitor registered at least four weeks before the start of the trade fair, pressure vessels requiring testing may be checked for approval until the day before the opening of the fair by the responsible expert, provided that the design pressure and water test pressure certificates are submitted and a technician is on hand at the trade fair stand.

### 5.6.3.3 Rental Devices

---

Since foreign pressure vessels cannot be checked during the relatively short stand construction period, preference should be given to using tested rental devices.

### 5.6.3.4 Monitoring

---

The necessary approval certificates have to be kept ready for inspection by the Staatliches Amt für Arbeitsschutz (State Agency for Industrial Safety) during the entire trade fair.

## Technical Guidelines

### 5.6.4 Exhaust Gases and Vapors

---

Hazardous, flammable, damaging, or generally intrusive vapors or gases from exhibits and equipment may not be emitted in the halls. They have to be channeled outside via pipes in accordance with the Bundesimmissionsschutzgesetz (Federal Emissions Protection Law) in the currently valid version.

### 5.6.5 Exhaust Gas Facilities

---

For exhibition halls equipped with exhaust gas facilities, see 3.1.

Depending on the location, flue gas extractors may be ordered under "exhaust vent installations" in the order media of ASG/Koelnmesse. ASG/Koelnmesse charges the exhibitor for the cost of the installation according to the information given in the bill of delivery and assembly.

The connection to the installation provided by ASG/Koelnmesse must comply with the valid ordinances and technology regulations.

## 5.7 Use of Compressed Gases, Liquid Gases and Combustible Fluids

### 5.7.1 Compressed Gas and Liquid Gas Facilities

---

The storage and use of compressed and liquid gas within the halls and on the fair grounds is prohibited without the express written permission of ASG/Koelnmesse.

#### 5.7.1.1 Approval Request for Compressed Gas Bottles

---

If liquid gases or other combustible gases in compressed gas bottles are used to present exhibits, the request for permission must be made in writing (6) weeks prior to the start of the event. The compressed gas bottles have to be protected against impacts, from falling over, from access by unauthorized persons and against heat etc. in accordance with the relevant regulations (see 5.7.1.2).

#### 5.7.1.2 Use of Liquid Gas

---

The compressed gas bottles used may not have a capacity of more than 11 kg. The amount on hand may not exceed the needs for one day (e.g.: 20 flames with an operating time of 4 hours per day equals 10,400 grams).

Open fires must be at least 1.50 metres distant from any essential escape routes. They are to be separated from the escape routes.

No combustible materials may be located within a radius of one metre surrounding the presentation devices. Liquid gas containers may not be deposited in staircases or emergency doors or in their immediate vicinity.

They must be protected against impact, falling over, access by unauthorized persons and heat in accordance with the regulations contained in the Operational Safety Ordinance (BetrSichV) in connection with the valid technical guidelines.

The distance between liquid gas containers and sources of radiant heat must be sufficient to ensure that the liquid gas in the bottles is not heated above 40 °C. The heat protection screen must be made of non-combustible building materials. It must be securely positioned between the heat-source and the bottles.

For drawing off liquid gas from the gas phase, the bottles must be connected in the upright position.

The consumption rate of the devices connected to a bottle may not exceed a total of 1.5 kg of gas per hour.

#### 5.7.1.3 Setup and Maintenance

---

When setting up and maintaining the liquid gas facilities, the BetrSichV in connection with the valid technical guidelines must be adhered to (in particular the „Technische Regeln Flüssiggas“ TRF published by the DVGW Deutscher Verein des Gas- und Wasserfaches e.V. and the DVFG Deutscher Verband Flüssiggase e.V. as well as the „Richtlinien für die Verwendung von Flüssiggas DGUV V79“ published by the Hauptverband der gewerblichen Berufsgenossenschaften).

### 5.7.2 Combustible Fluids

---

#### 5.7.2.1 Storage and Use

---

The storage or use of flammable liquids as defined by the Hazardous Substance Ordinance (GefStoffV) within the halls and on the fair grounds is prohibited without the express written permission of ASG/Koelnmesse. Permission for the storage and use of such liquids can

## Technical Guidelines

be granted for operating or presenting exhibits. A corresponding request has to be sent to ASG/Koelnmesse along with a requisite safety data sheet. Insofar as the storage or use of such liquids is permitted, the regulations contained in the existing technical guidelines and the currently valid versions of the Operational Safety Ordinance and the Hazardous Substance Ordinance must be adhered to.

### 5.7.2.2 Storage of Required Amounts

---

Only as much combustible liquid as is needed for operation and presentation for one day may be stored at the stand. The amount required must be specified in the request.

### 5.7.2.3 Storage Containers

---

The amount required for one day has to be stored in closed, fracture-proof containers arrayed in a clearly structured manner. They must be inaccessible to unauthorized persons. The storage containers have to be located in non-combustible collecting basins.

### 5.7.2.4 Storage Location

---

Smoking is strictly prohibited at the storage location. The area must be equipped with the appropriate signs. Suitable fire extinguishing equipment must be on hand.

### 5.7.2.5 Conditions for Operating

---

Facilities that are operated or presented with combustible fluids must be fitted with non-combustible collection containers at the filler necks and any positions where fluids could escape. Due to the danger of fire and explosion, combustible fluids that have leaked into the collecting basins must be immediately removed and disposed of in a safe manner.

### 5.7.2.6 Filling With Liquids

---

Since the process of filling the liquids into containers is especially dangerous, it must be done with the utmost care and caution. Spilt liquids or contamination caused by container leakages must be removed and disposed of immediately. Therefore, it is essential that the appropriate precautions be taken and drip containers or absorbents be kept on the stand at all times.

### 5.7.2.7 Empty Containers

---

Empty containers that once held combustible liquids may not be deposited or stored at the stand or in the halls.

## 5.8 Asbestos and Other Dangerous Substances

The application or use of building materials containing asbestos or other asbestos-containing products or other dangerous substances is forbidden. This regulation is based on the Chemisches Gesetz (Law for Protecting Against Harmful Substances) in the currently valid version as well as on the Chemikalien-Verbotsverordnung (Regulation on the Prohibition of Chemicals) and the Gefahrenstoffverordnung (Dangerous Materials Regulation) in the currently valid versions.

## 5.9 Film, Photography, Television and Other Types of Presentations

Auditoriums must have at least two direct exits to the hall gangways. These exits must be as far apart from each other as possible. Auditoria require a special permit if they can hold more than 200 spectators (see 4.2.1).

## 5.10 Radiation Protection

### 5.10.1 Radioactive Materials

---

A special permit is required to use radioactive materials. The permit has to be requested from the responsible authorities in accordance with the Radiation Protection Regulation (the currently valid version) and submitted to ASG/Koelnmesse at least six weeks prior to the start of the trade fair. If a permit has already been granted, it must be proved that the planned use of radioactive materials at the exhibition center is in accordance with all legal requirements.

### 5.10.2 X-Ray Facilities and Interference Radiators

---

The Regulation for the Protection from Damage through X-Rays (RöV, BGI Part I, currently valid version) must be adhered to.



## Technical Guidelines

The operation of x-ray facilities and interference radiators is subject to approval and/or requires notification in accordance with Articles 3, 4, 5, 8 RöV. The requests or notifications must be submitted to the authorities responsible at least four weeks prior to the start of the event and in three copies each. ASG/Koelnmesse must also be notified of any plans to operate such equipment.

### 5.10.3 Laser Facilities

---

Koelnmesse/ASG must be notified of any plans to operate laser facilities six (6) weeks prior to the start of the event.

If certain laser facilities are to be used, the responsible authority and accident insurer have to be notified in accordance with Article 6 of the BGV B2 regulation concerning laser radiation.

The notification must be accompanied by the written appointment of a laser protection officer for the operation of the laser facility. The authority responsible is the Bezirksregierung Köln, Dezernat 56/8 Betrieblicher Arbeitsschutz, Postal address: 50606 Köln, Germany, Tel.: +49 221 147-0, Fax: +49 221 147-2469.

### 5.11 High-Frequency Devices, Radio Systems, Electromagnetic Compatibility and Harmonic Oscillations

High-frequency devices, radio systems and other transmitters for communication purposes, radio paging systems, microport facilities, intercoms and telecontrol installations may only be operated with the permission of the Regulatory Authority for Telecommunications and Posts. Their use must be coordinated with ASG/Koelnmesse to ensure that frequencies are distributed evenly and the possibility of interference is excluded.

High-frequency devices and radio systems may only be operated if they are in accordance with the Gesetz über Fernmeldeanlagen (Radio System Law), BGGI, and the Gesetz über elektromagnetische Verträglichkeit von Geräten – EMVG (Law on the electromagnetic Compatibility of Devices BGGI) in the currently valid versions.

If exhibits or stand decorations that use electrical, magnetic or electromagnetic fields are set up, the conditions contained in the 26<sup>th</sup> Ordinance on the Implementation of the Federal Ambient Pollution Control Act must be adhered to.

The electrical installations of these exhibits and stands must be installed in such a way that there are no impermissibly high phase effects in the trade fair supply network due to harmonic oscillations (see also 5.3.3).

### 5.12 Cranes, Fork-Lift Trucks, Lifts, Empty Containers, Trade Fair Forwarding Agent, Customs

Only contract partners of ASG/Koelnmesse are permitted to use cranes, self-propelled forklift trucks with driver seat, electric scissor lifts, telescoping lifts and similar hall vehicles resp. workshop platforms in the exhibition centre.

The charging of the accumulators of work platforms, etc. within the halls, in passages and entrances is not permitted

Empty containers may not be stored in the exhibition halls. The contract carrier of ASG/Koelnmesse offers storage options.

Each exhibitor can freely choose which shipping company will transport the exhibits to and from the exhibition center. ASG recommends using the contract transport agency of ANGA COM. Please consult the order form for details.

#### 5.12.1 Customs Clearance

---

The customs office H.Z.A. Koeln-Deutz, office Koelnmesse, is situated in the fair grounds = Messe-Speditionshof. This office is competent for the clearance of exhibition goods, call number: +49 221 821 28 58.

It is recommended to entrust the contract forwarding agent with the customs clearance of the exhibition goods.

The representatives abroad of the contract forwarding agent will arrange the customs clearance and prompt dispatch of the exhibition goods. The address can be requested from the foreign representatives of Koelnmesse and from the contract carrier. In Cologne the exhibition goods will be cleared by the contract forwarding agent for temporary importation, as well as for definite importation on request. The contract forwarding agent will deposit the necessary guarantee at the customs authority. In case of final import clearance the contract forwarding agent will advance the import duties and taxes.

For customs clearance three copies of proforma invoice in German are required.

In order to avoid customs penalties the contract forwarding agent draws your attention to the following facts:

- All customs and transport documents for goods arriving from abroad and destined to the Koelnmesse have to be presented to the contract forwarding agent for clearance before being delivered to the stand.
- All goods cleared for temporary importation which will be either re-forwarded abroad or in the Federal Republic of Germany have to be presented to customs for examination and cleared by the contract forwarding agent. The contract forwarding agent will issue the

## Technical Guidelines

necessary customs transit document on the office of destination. This document will be handed to the exhibitor or carrier. The receiver of this document is obliged to present the documents and the goods to the customs office of destination immediately after arrival in order to arrange clearance.

In case of contravention the exhibitor has to pay the duties or to refund them to the contract forwarding agent. Furthermore the consignee must count upon a penal prosecution on behalf of the German or foreign customs authorities.

### 5.13 Musical Renditions

Musical renditions of all kinds require the approval of GEMA (German Authors' Rights Society) in accordance with Copyright Law. If musical renditions have not been approved, GEMA can file for damages according to Article 97 of the Copyright Law.

Address registrations and queries to:

GEMA-Bezirksdirektion Stuttgart  
Key Account Management Messe  
Herdweg 63, 70174 Stuttgart, Germany  
Phone: +49 711 2252-794, Fax: +49 711 2252-800  
E-Mail: messe@gema.de, Web: www.gema.de/messen

Acoustic and visual presentations must also be approved by ASG. The permit is issued under the condition that the sound volume will not exceed 70 decibels and the presentation does not interfere with work at the neighboring stands in any way.

If these regulations are repeatedly violated, the power supply to the exhibitor's stand can be interrupted regardless of the effect on the stand as a whole. The exhibitor is not entitled to compensation for any damage suffered directly or indirectly due to the interruption in the power supply. The burden of proof of compliance with the regulations lies with the exhibitor.

### 5.14 Drink Dispensing Machines

The currently valid version of the Workplace Safety Ordinance – BetrSichV – must be complied with during the setup and operation of beverage dispensing facilities at the stand. It is not necessary to notify the City of Cologne.

### 5.15 Food Monitoring

When providing food samples that are to be consumed at the event (whether for a fee or free of charge), you must comply with the applicable legal regulations that are valid in the Federal Republic of Germany, and, in particular, with Germany's Food Hygiene Regulation (LMHV). The following labelling regulations are particularly relevant and apply in their respective current versions: Regulation (EU) No 1169/2011 on the provision of food information to consumers and its implementing regulation, Germany's Additives Approval Regulation (ZZuV), Regulation (EC) No 1333/2008 on food additives, Germany's Fruit Juice and Soft Drink Regulation (FrErfrischGetrV), and Regulations (EC) No 1829/2003 and 1830/2003 concerning the traceability and labelling of genetically modified organisms and the traceability of food and feed products produced from genetically modified organisms.

If you have any questions, please contact the City of Cologne:

Stadt Köln  
Umwelt- und Verbraucherschutzamt  
Lebensmittelüberwachung und Veterinärdienst  
Friedrich-Ebert-Ufer 64 – 70, 51143 Köln, Deutschland  
Telefon: +49 221 221-26934  
e-mail: lmk.vetleb@stadt-koeln.de

### 5.16 Import of Meat and Meat Products

Please note that health certificates and edibility certificates have to be presented to the authorities of the importing country when importing meat or meat products. This is also the case when the goods are brought to Germany for an event.

These certificates must be presented as originals and in German, and must include the certified veterinary control number.

If the processing facility in your country is not authorized to export meat to the Federal Republic of Germany, the responsible authority can issue a special permit.

## Technical Guidelines

Please contact the responsible veterinary office in good time before importing meat or meat products into Germany or contact the forwarding agent of ASG.

### 6 Environmental Protection

ASG/Koelnmesse have accepted their responsibility to practice preventive environmental protection.

As contracting partners of ASG/Koelnmesse, the exhibitors are obliged to ensure that all provisions and regulations relating to environmental protection also have to be strictly observed by his contract partners (i. e. stand constructors).

#### 6.1 Waste

All of the following provisions are based on the Kreislaufwirtschaftsgesetz (KrWG) in the currently valid version, associated implementation provisions as well as state law and the municipal statutes.

Exhibitors and their subcontractors are obliged to effectively contribute to the avoidance of waste during every phase of an event. This goal has to be pursued in coordination with all participants, starting in the planning phase. In general, reusable and environmentally compatible materials should be used for stand construction and operation.

##### 6.1.1 Waste Disposal

---

The exhibitor is responsible for the orderly and environmentally-friendly disposal of waste that occurs during the assembly, dismantling and operation of his stand.

The exhibitor is the generator of this waste.

1. The exhibitor will manage the disposal of the waste outside of the fair grounds himself and at his own expense.
2. A cleaning company that is authorised by the trade fair organisation and assigned with the waste disposal can be commissioned with this task under the rubric "Waste Disposal" in the ordering media of ASG/Koelnmesse.

The exhibitors agree to ensure that their stand areas are clean when they hand them over after the event has finished.

It is expressly forbidden to dispose of waste in foreign waste containers or other equipment of the fair grounds.

The assembly and dismantling of the trade fair operations must not be restricted. If no binding order has been received by the closing deadline, the trade fair organisation assumes that the exhibitor will take care of the disposal of the waste at his own cost and risk.

The placement of containers for waste disposal requires authorisation and is subject to a fee. In this connection, please see the regulation under point 4.2.2 of these technical guidelines.

The trade fair company will assign a cleaning company to dispose of waste that has not been or that has not been completely removed by the exhibitor at the cost of the respective exhibitor. Waste that remains in the exhibition halls will be estimated in m<sup>3</sup> and calculated at the prices stated under waste disposal in the ordering media. The obligation to dispose of all waste in an orderly manner is also to be enforced upon the contract partners (i.e. stand builders) commissioned by the exhibitors.

The obligations regarding avoiding waste, disposing of waste and the bearing of the costs listed here also apply for the stand builders.

##### 6.1.2 Dangerous Waste

---

The exhibitors and their contract partners (i.e. stand builders) are obliged to dispose of all waste that arises in line with the valid legal and other regulations. This particularly applies for waste that is classified as being dangerous according to the Waste Catalogue Ordinance (AVV in its current version). Dangerous waste includes among others batteries, solvents, lubricants, varnish, paint, fluorescent bulbs, electric devices. This dangerous waste must not be mixed under the stand assembly waste. Should the exhibitor wish for this waste to be disposed of, the cleaning service providers of ASG/Koelnmesse have to be commissioned with the task separately. Additional costs for the disposal of unlawfully mixed waste will be invoiced to the perpetrator plus the coordination expenses. The exhibitor is responsible for monitoring the orderly disposal of waste.

## Technical Guidelines

### 6.1.3 Waste which has Been Brought on Site

---

It is not permitted to bring materials and waste that do not arise during the event or during the assembly and dismantling work onto the grounds.

## 6.2 Water, Waste Water, Ground Protection

### 6.2.1 Oils, Fat Collectors

---

It is forbidden to release solvent-based substances (i.e. paints, varnishes) into the wastewater system. This particularly applies for the rinsing and cleaning of tools.

Discharges into the waste water system may not exceed the normal pollutant limits for households. If the waste water to be discharged contains oils and/or fats that exceed this limit, oil/fat collectors must be used. These have to comply with the generally accepted technical regulations.

If mobile catering services are used, it must be ensured that fats and oils are collected and disposed of separately. The provisions of the Waste Water Ordinance of the City of Cologne (particularly discharge prohibitions and the threshold values) must be adhered to for discharges into the waste water system.

Further information:

Stadtentwässerungsbetriebe (StEB) Köln, AöR

Ostmerheimer Str. 555

51109 Köln, Germany

Phone: +49 221 221 26868

### 6.2.2 Cleaning / Cleaning Company

---

ASG/Koelnmesse's contracting companies can be commissioned to clean the stands if the exhibitor fills out the corresponding order media. During the event, cleaning work may only be carried out by ASG/Koelnmesse's contracting company.

## 6.3 Environmental Damage

Koelnmesse/ASG must be notified immediately if there is any damage to the environment, or pollution (e.g. due to gasoline, oil, solvents, paints). Cleaning work must generally be carried out with biodegradable products. Cleaning agents that contain solvents that are detrimental to health are to be used in compliance with the applicable regulations and only in exceptional cases.

## 7 Miscellaneous

### 7.1 Insurance / Stand Guards

#### 7.1.1 Insurance

---

The organiser doesn't take out any special insurance for the stand and the items on the stand. The organiser recommends that the exhibitor protects his participation risk against the usual insurable risks such as fire, burglary, theft, damage, water damage, etc., including the risks of transportation to and from the fairgrounds at his own expense and that he provides sufficient insurance cover for the duration of the trade fair as well as during the assembly and dismantling time, including the period of transportation to and from the trade fair. The exhibitor can cover his own participation risk at his own expense via the insurer of the organiser. More information about KBI-TR-Duesseldorf@ergo.de.

#### 7.1.2 Stand Guards

---

ASG/Koelnmesse staff monitor the halls and outdoor area for the duration of the event. Security staff offer a limited supervision service during the construction and dismantling periods. Security companies with uniformed security guards and control personnel in civilian dress are commissioned to handle the general security in the halls and outdoor area, as well as controlling the entrances. All those present in the trade fair halls or outdoor area must be in the possession of a valid entrance ticket and be prepared to present this to security for inspection on demand.

## Technical Guidelines

The security and monitoring of individual exhibitors' stands or areas of stands is not included in general security and is the responsibility of the exhibitors themselves. Under "Stand security" in the order media of ASG/Koelnmesse, the exhibitor can commission the services of stand security personnel.

### 7.2 Arranging Personnel

Detailed information can be found in the order media of ASG/Koelnmesse under "Hostesses/services staff" and under "Construction/dismantling staff".

### 7.3 Hotel / Travel Services

ASG/Koelnmesse's hotel service provides exhibiting companies with advice and assistance on accommodations. This service also can be used for their customers' accommodation needs.

Koelnmesse GmbH  
Postfach 21 07 60, 50532 Koeln, Germany  
Phone: +49 221 821-3998, fax: +49 221 821-3999  
E-mail: [services@exhibitor.koelnmesse.de](mailto:services@exhibitor.koelnmesse.de)  
[www.hotelzimmerbuchung.com](http://www.hotelzimmerbuchung.com)

To learn about further travel services or book private accommodation, go to [www.koelnmesse.de](http://www.koelnmesse.de) and click on "Hotel/Travel Services".

### 7.4 Rental Furniture and Equipment

The contracting companies commissioned by ASG/Koelnmesse rent out furniture, kitchen equipment and refrigeration appliances to exhibitors. Please refer to the appropriate order form for more detailed information.

### 7.5 Catering

On behalf of ASG/Koelnmesse, the following company will be providing catering services for the exhibitors, visitors, stand construction personnel and other individuals at the Cologne exhibition centre:

Aramark Restorations GmbH  
Deutz-Mülheimer Straße 109, 51063 Köln  
Phone: +49 221 284-8584, Fax: +49 221 284-/8599  
E-Mail: [aramark@catering-koelnmesse.com](mailto:aramark@catering-koelnmesse.com)

ASG/Koelnmesse operates all the equipment for the hall catering service and the banqueting halls.

With the assistance of Aramark GmbH, ASG/Koelnmesse also offers catering delivery service (see "Catering services" in the ASG/Koelnmesse order media) and will provide individual quotes upon request. Koelnmesse's partner, Aramark GmbH, provides you with the certainty that it fulfills all the legal requirements for operating catering facilities.

However, if you commission other companies to provide catering services at your stand or offer them yourself, then it is your responsibility to ensure that all legal requirements valid in the Federal Republic of Germany, and in particular those that pertain to food hygiene, are complied with and that the required licences have been granted. Among other things, you have to make sure that the certificates of the public health authority (Gesundheitsamt) (§ 43 Par. 1 InfSG) and the current instruction documents (§ 43 Par. 4 InfSG) are kept on hand at the catering units. To maintain its high quality standards and good reputation, ASG/Koelnmesse conducts spot checks to see the hygiene requirements are met, even though it is not obligated to do so. ASG/Koelnmesse can order stand catering services to be terminated if hygiene requirements are seriously violated.

## Technical Guidelines

### List of keywords

#### **A** Point

Abrasive cutting and grinding work	4.4.1.10
Advertising material	4.7.7
Advertising space	4.7.7
Appliances when using gas	5.7.1.3
Approval confirmation	5.6.3.1
Approval of constructions requiring a permit	4.2.1
Approval request for compressed gas bottles	5.7.1.1
Arranging personnel	7.2
Asbestos	5.8
Ash containers	4.4.1.7
Ashtrays	4.4.1.7
Assembly regulations (electrical installation)	5.3.3

#### **B** Point

Balloons	4.4.1.5
Barrier-free access	4.7.8

#### **C** Point

Catering	7.5
Catwalks	4.6
Cellulose nitrate lacquer	4.4.1.9
Changes to the substance of the building (stand design)	4.7.3
Checking of constructions requiring a permit	4.2.1
Checking the rented area	4.7.2
Cleaning / cleaning agents	6.2.2
Combustible fluids	5.7/5.7.2
Communications facilities	3.1.3
Compressed air	3.1.2/5.5.1
Compressed gas	5.7
Conditions for operating (compressed gases, liquid gases and combustible fluids)	5.7.2.5
Connections (electrical)	5.3.1
Construction height	4.3
Construction times	1.2.1
Containers (stand construction authorisation)	4.2.2
Cranes	5.12
Customs	5.12
Customs clearance	5.12.1

#### **D** Point

Damages	5.1.1
Dangerous waste	6.1.2
Decoration materials (fire protection and safety regulations)	4.4.1.1
Dismantling times	1.2.1
Doors	4.5.2
Drink dispensing machines	5.14
Duration of event	1.2.2

#### **E** Point

Electrical appliances (rental)	7.4
--------------------------------	-----

Electrical installation	5.3
Electrical supply	3.1.2
Electromagnetic compatibility	5.11
Elevators	3.1.c
Emergency evacuation	2.6
Emergency exits	2.2.2
Emergency hatches	2.2.2
Empties	4.4.1.11/5.12
Empty containers (use of compressed gases, liquid gases and combustible fluids)	5.7.2.7
Environmental damage	6.3
Environmental protection	6
Equipment safety law	5.6.2
Escape routes	2.2/4.5/4.5.1
Exhaust gas facilities	5.6.5
Exhaust gas	5.6.4
Exhibition of motor vehicles	4.4.1.2
Exits	4.5/4.5.1
Explosive materials / munitions	4.4.1.3

#### **F** Point

Faults	3.1.6
Filling with liquids (use of compressed gases, liquid gases and combustible fluids)	5.7.2.6
Fire department operation zones	2.2.1
Fire extinguishers	4.4.1.12
Fire protection	4.4.1
Fire regulations	4.4
Fireproof door shutters	3.1.d
Fog machines	4.4.1.6
Food monitoring	5.15
Fork-lift trucks	5.12
Forwarding agents	5.12

#### **G** Point

Gas / gas installations	5.5.2/5.5
Gates	3.1.e
General lighting	3.1.1
General regulations	5.1
Glass and acrylic glass	4.4.3
Grease traps	6.2.1
Ground protection	6.2
Ground regulations	1.1

#### **H** Point

Hall aisles	2.2.2
Hall data	3.1
Hall fittings	3
Hall flooring	4.7.4
Hall height (clear span)	3.1.b
Hanging objects from the hall ceiling	4.7.5
Harmonic oscillations	5.11
Hazardous substances	5.8
Heating	3.1.5
High-frequency systems	5.11

## Technical Guidelines

Hotel room reservations	7.3
House regulations	1.1
Hydrants	2.2.1
<b>I</b>	<b>Point</b>
Import of meat and meat products	5.15.1
Insurance	7.1/7.1.1
Interference radiators	5.10.2
<b>K</b>	<b>Point</b>
Kitchen equipment (rental)	7.4
<b>L</b>	<b>Point</b>
Ladders	4.6
Laser facilities	5.10.3
Liquid gas facilities	5.7.1
Liquid gases	5.7
<b>M</b>	<b>Point</b>
Machine noise	5.6.1
Machinery	5.6
Maintenance when using gases	5.7.1.3
Meeting places	4.4.4
Modifications to non-regulation components	4.2.3
Monitoring (machine, pressure vessel and exhaust gas facilities)	5.6.3.4
Musical renditions	5.13
<b>N</b>	<b>Point</b>
Non-recyclable waste containers	4.4.1.8
<b>O</b>	<b>Point</b>
Oils	6.2.1
Opening times	1.2
Operating ban	5.6.2.3
Operating regulations	5.3.3
Operational safety	5
Outdoor area	3.2/4.8
Overview of the hall layout	3.1.a
<b>P</b>	<b>Point</b>
Photographic presentations	5.9
Platforms	4.6
Preliminary notes	1
Presentation (stand design)	4.7.1
Presentations	4.7.7/5.9
Pressure vessels	5.6/5.6.3
Product safety law	5.6.2
Pyrotechnics	4.4.1.4
<b>R</b>	<b>Point</b>
Radiation protection	5.10
Radio systems	5.11
Radioactive substances	5.10.1
Recycling containers	4.4.1.8

Refrigerators (rental)	7.4
Rental devies (machine, pressure vessel and exhaust gas facilities)	5.6.3.3
Rental furniture	7.4
<b>S</b>	<b>Point</b>
Safety devices	5.6.2.1
Safety equipment	2.3
Safety lighting	5.3.5
Safety measures	5.3.4
Safety regulations	4.4
Screening of films	5.9
Security	2.5/7.1
Service doors	3.1.d
Solvent-based paints	4.4.1.9
Spray guns	4.4.1.9
Sprinkler systems	3.1.4
Stand construction authorisation	4.2
Stand construction materials	4.4.1.1
Stand construction regulations	4
Stand covering	4.4.2
Stand design	4.7
Stand installation	5.3.2
Stand numbering	2.4
Stand partition walls	4.7.6
Stand safety	4.1
Steps	4.6
Storage containers (use of compressed gases, liquid gases and combustible fluids)	5.7.2.3
Storage location (use of compressed gases, liquid gases and combustible fluids)	5.7.2.4
Storage of gases and combustible fluids	5.7.2.1
Storage of required materials (compressed gases, liquid gases and combustible fluids)	5.7.2.2
System stands	4.7.6
<b>T</b>	<b>Point</b>
Technical data	3
Technical hall information	3.1.f
Technical regulations	5
Technical safety regulations	5
Technical supply	5
Television presentations	5.9
Tents	4.2.2
Testing procedures (machine, pressure vessel and exhaust gas facilities)	5.6.2.2
Traffic regulations	2.1
Transport	2
Two-storey constructions	4.9
Type of power / voltage	3.1.1
<b>U</b>	<b>Point</b>
Use of balloons	4.4.1.5
Use of combustible fluids	5.7.2.1

## Technical Guidelines

Use of compressed and liquid gases	5.7.2.1
Use of compressed gases	5.7
Use of flying objects	4.4.1.5
Use of tools	5.2
<b>V</b>	<b>Point</b>
Vapours (machine, pressure vessel and Exhaust gas facilities)	5.6.4
Vehicles	4.2.2
<b>W</b>	<b>Point</b>
Waste containers	4.4.1.8
Waste disposal	6.1.1
Waste management	6.1
Waste water	6.2
Waste water installation	5.4
Waste which has been brought on site	6.1.3
Water	6.2
Water installation	5.4
Water supply	3.1.2
Wi-Fi exhibitor networks	3.1.3
Work with open flames	4.4.1.10
<b>X</b>	<b>Point</b>
X-ray facilities	5.10.2